

Suitable for
**6 MONTHS
TO 8 YEARS**
(approximately)

Tuva

Harnessed Forward
Facing Car Seat

Instruction Manual

**IMPORTANT: KEEP THIS
BOOKLET IN THE PLACE
PROVIDED ON THE
CHILD RESTRAINT.**

Images and designs may vary



Scan QR code to view
video instructions



Quick Setup with Seatbelt

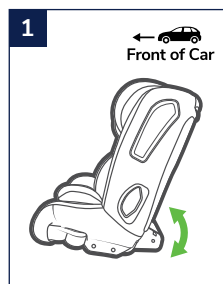

Adjust recline for comfort when needed.

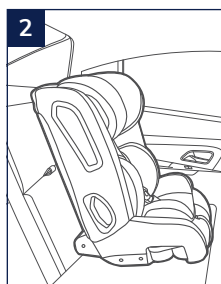

Place restraint in car.



Extend top tether webbing.

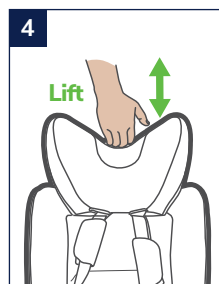

Raise headrest height.

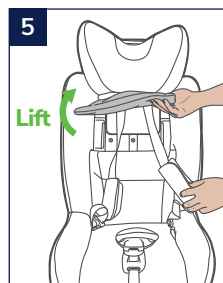

Lift upper back rest flap.

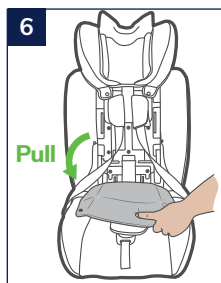

Pull down lower back rest flap.

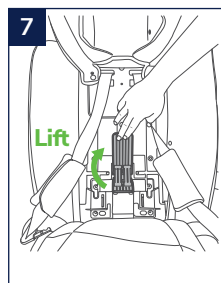

Lift SMART Lock lever.



Thread vehicle seat belt through belt path recess. Ensure seat belt sitting on the top of the webbing.

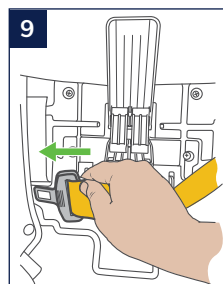

Pull the vehicle seat belt fast across the back and through to the other side. Fasten the seatbelt buckle. Ensure there are no twists.

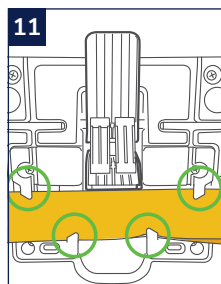

Thread seat belt so it sits in the channel under the guiding hooks.

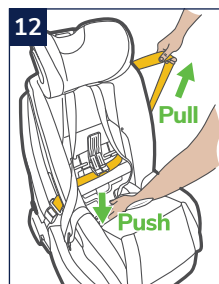

Remove slack from seat belt.

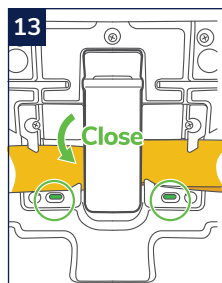

13
Close SMART Lock.
Ensure the tension
indicators shows full
green on both sides.



14
Attach the top tether
strap and remove
slack.

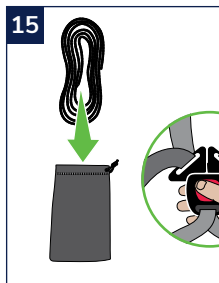

15
Store strap in storage
pocket.

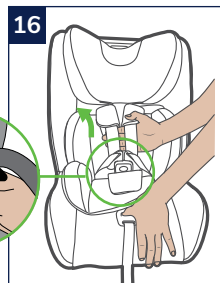

16
Loosen harness straps
and unlock harness
buckle.

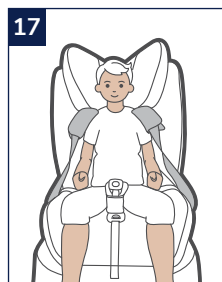

17
Place child in the
restraint.

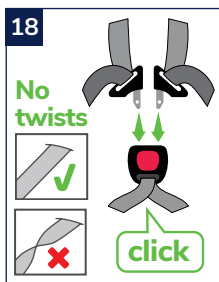

18
Engage harness buckle.
Ensure there are no
twists.

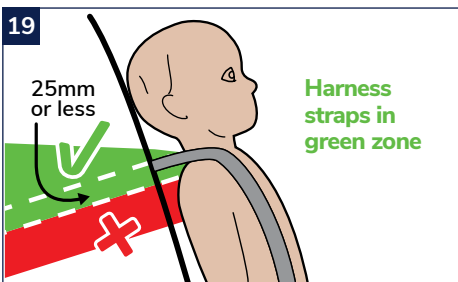

19
The shoulder straps must be in the slots which
are nearest to the child's shoulders but not
more than 25mm below the child's shoulders.



20
Double check shoulder
height markers.

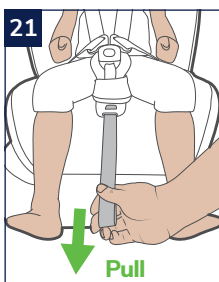

21
Pull on harness straps
to remove slack.

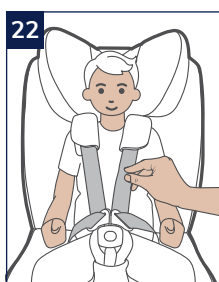

22
If you can pinch the
harness strap length,
tighten more.

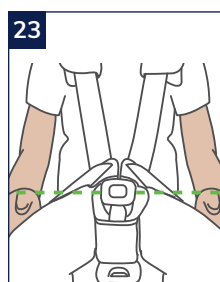

23
Adjust crotch strap
length if necessary -
See page 28 for more
detail.

Welcome to the Maxi-Cosi family!

Congratulations on the purchase of your brand new Maxi-Cosi seat. Please take the time to read through these instructions carefully.

Our vision at Maxi-Cosi is to help parents as their families grow, and like an embrace that carries a child before they can walk, we've helped millions of families at the start of their new life.

It was over 40 years ago that we launched Europe's first baby seat and since then, we've carried over 60 million babies home from the hospital! We were pioneers then, and we're pioneers now. We will never stop improving, designing, and perfecting the way new families move around the world - wherever life's adventures may take them.



Air Protect® Superior Side Impact Protection

Air Protect® is designed to reduce the severity of side impact crash forces by absorbing the energy and transferring that energy away from your child's head giving your child 180 degree protection in the instance of an accident



SMART Lock

Maxi-Cosi SMART Lock has been specifically designed to make installation simple and effortless. The SMART Lock is a clamp-style mechanism that secures your seat in place, creating a tighter, safer and more secure fitment.



Accident Exchange

As a safety brand, we want to offer the best possible support during this time. In the event of a car accident your seat may have unseen damage. The Maxi-Cosi Accident Exchange Service* offers new for old replacement of your seat, giving you peace of mind. One less thing to worry about as a new parent.



* Register your product at maxi-cosi.com.au/service/warranty-registration

Contents

Quick Setup	2
Warnings	6
Shoulder Height Markers	8

Forward Facing

Components	10
Padding and Insert	12
Preparation before install	13
Install using Vehicle Seatbelt	18
How to use	25

Additional Information

Seat Guide	32
Care and Maintenance	33
Install Upper Anchorage	39
Accessories	41
Seat Guide	42
Guarantee	43



WARNINGS

Read and follow all of the installation instructions for maximum protection. If you have any questions regarding the installation or use of this restraint, please contact Dorel Australia or agent, or a child restraint fitting station authorised by the relevant transport authority, or in New Zealand, to consult the agent for the vehicle.

To be used only in a forward-facing position by a child whose shoulders are above the lower shoulder height marker (approximately 6 months of age) until the child's shoulders reach the upper shoulder height marker (approximately 8 years of age).

Continue to use this child restraint until the child reaches this limit.

Do not use this child restraint until child's shoulders are above the lower shoulder height marker.

Infants are at risk of serious injury if they face forward too early.

Children are at risk of serious injury if they move to booster seats too early.

Just using a seatbelt is not recommended for children that have outgrown this restraint. Children are safest in a booster seat until their shoulders reach the upper shoulder height marker of the booster seat.

TO BE USED WITH A LAP-SASH OR LAP ONLY SEATBELT IN THE FRONT/BACK OF MOST CARS WITH Forward Facing SEATS.

The use of child restraints in the front seat may be restricted for children of specific ages by local legislation. Please check with your local legislation regarding any restriction for child restraint.

THIS RESTRAINT MUST BE ATTACHED TO A CHILD RESTRAINT UPPER ANCHORAGE POINT IN THE CAR. REFER TO CAR OWNER'S HANDBOOK FOR LOCATION OF UPPER ANCHORAGE POINTS. REFER TO A CHILD RESTRAINT FITTING STATION IF NO UPPER ANCHORAGE POINTS ARE IN THE MOTOR CAR.

This child restraint is not suitable for use on an aircraft.

Always store the instruction book in the pocket provided at the rear of the seat.

Fit the restraint firmly to the car seat.

Fit the harness firmly to the child.

A loose restraint or harness is dangerous.

Supervision of children is needed because they may be able to undo the buckles.

Use the restraint exactly as shown in the instructions.

DO NOT LEAVE CHILDREN UNATTENDED IN THE CAR.

Do not alter or modify this restraint.

Repairs must only be done by the manufacturers or agent.

Do not allow the restraint to come into contact with polishes, oils, bleach and other chemicals.

Destroy the restraint if it has been in a severe crash, even if no damage is visible.

DO NOT USE THIS RESTRAINT WITHOUT THE COVER.

Always secure the loose end of the top tether strap to prevent it hanging out of the car or being accessible by the child.



WARNINGS

Top Tether Strap:

ALWAYS ATTACH HOOK AND REMOVE SLACK.

THIS RESTRAINT IS NOT SUITABLE FOR USE WHERE THE TOP TETHER STRAP MAY FALL INTO A SPLIT IN THE SEAT BACK OR OFF THE SIDE OF THE SEAT.

DO NOT ATTACH THIS CHILD RESTRAINT TO ANY ISOFIX LOW ANCHORAGE.

ISOFIX low anchorages in cars are designed to withstand only those loads imposed by children aged up to approximately 4 years of age in a correctly fitted and approved ISOFIX compatible child restraint. This child restraint is not approved for use with the car's ISOFIX low anchorages.

IF AN AIRBAG IS FITTED IN THE SEATING POSITION WHERE THE CHILD RESTRAINT IS TO BE FITTED, FOLLOW THE VEHICLE MANUFACTURERS WARNINGS AND INSTRUCTIONS.

The restraint should not be purchased or sold as a second hand item. It is recommended not to use child restraints older than 10 years as the protection in an accident may be reduced.

This restraint must be used in conjunction with a lap or lap-sash seatbelt.

Seatbelt extenders are not recommended to be used if the seatbelt is not long enough to secure the child restraint. If seatbelts are too short then seek advice from a child restraint fitter and consider their recommendations.

Use of aftermarket accessories (i.e. items not provided in the box with the child restraint), can reduce the safety provided by child restraint and may cause injury or death. For approved aftermarket accessories please refer to (page 37) and ensure they are compliant with AS/NZS 8005.

No child restraint can guarantee absolute protection from a crash. However proper use of this restraint may reduce the risk of injury or death.

此安全座椅仅适合正向安装。此产品适用于肩膀超过下肩高标记的婴儿及儿童（大约6个月的宝宝及以上），直到儿童肩膀达到上肩高标记（大约8岁的儿童）。

Shoulder Height Markers

Forward Facing

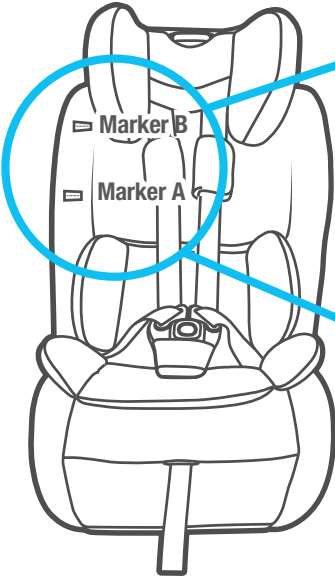

**SHOULDERS BELOW THIS LINE WHEN
HEADREST AT HIGHEST POSITION**

SHOULDERS MUST BE

ABOVE THIS LINE

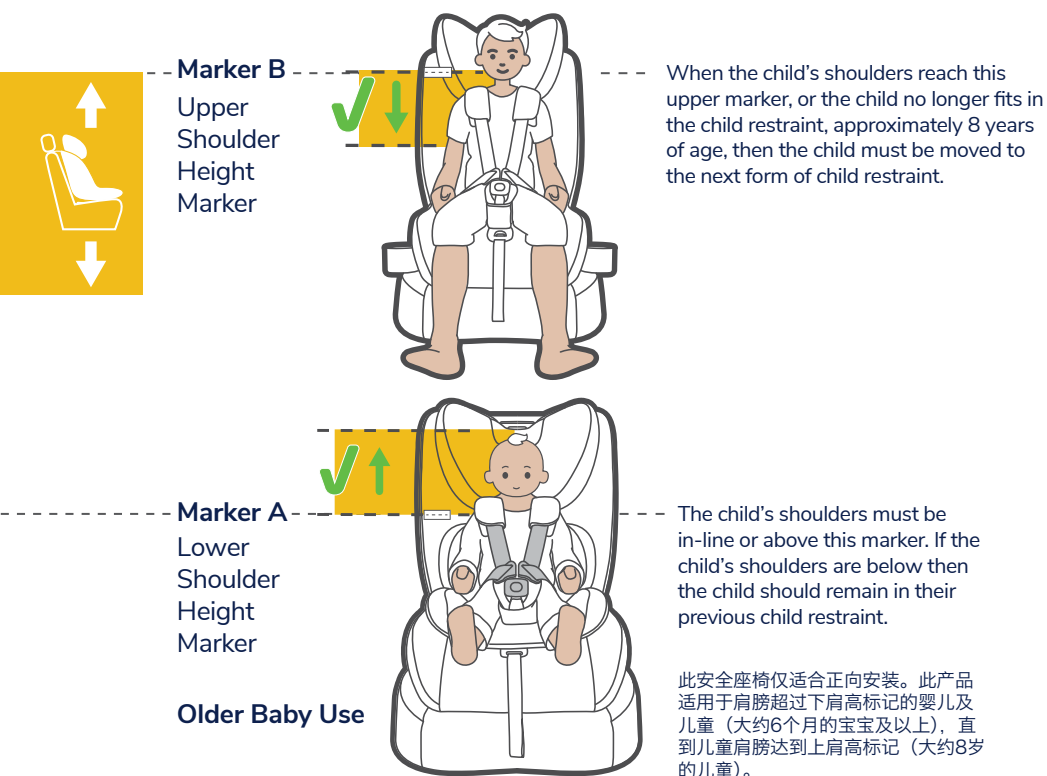
Child Use

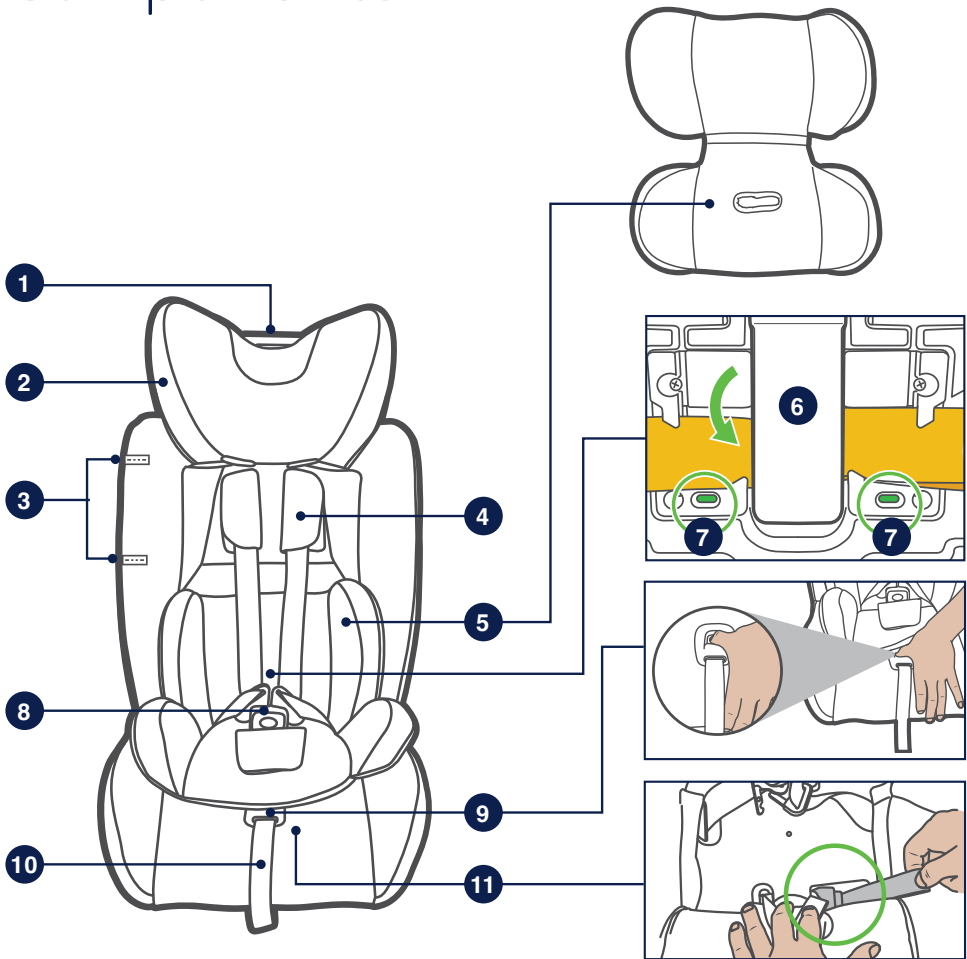

Components



1. Adjustable Headrest handle
2. Air Protect (x2)
3. Shoulder Height Markers
4. Belt Mates x 2
5. Padded Insert
6. SMART Lock
7. Belt Tension Indicators (x2)
8. Buckle
9. Harness Release button (under the trim)
10. Harness Adjuster Strap
11. Crotch Buckle Height Adjuster (under the trim)

FORWARD-FACING BELT PATH

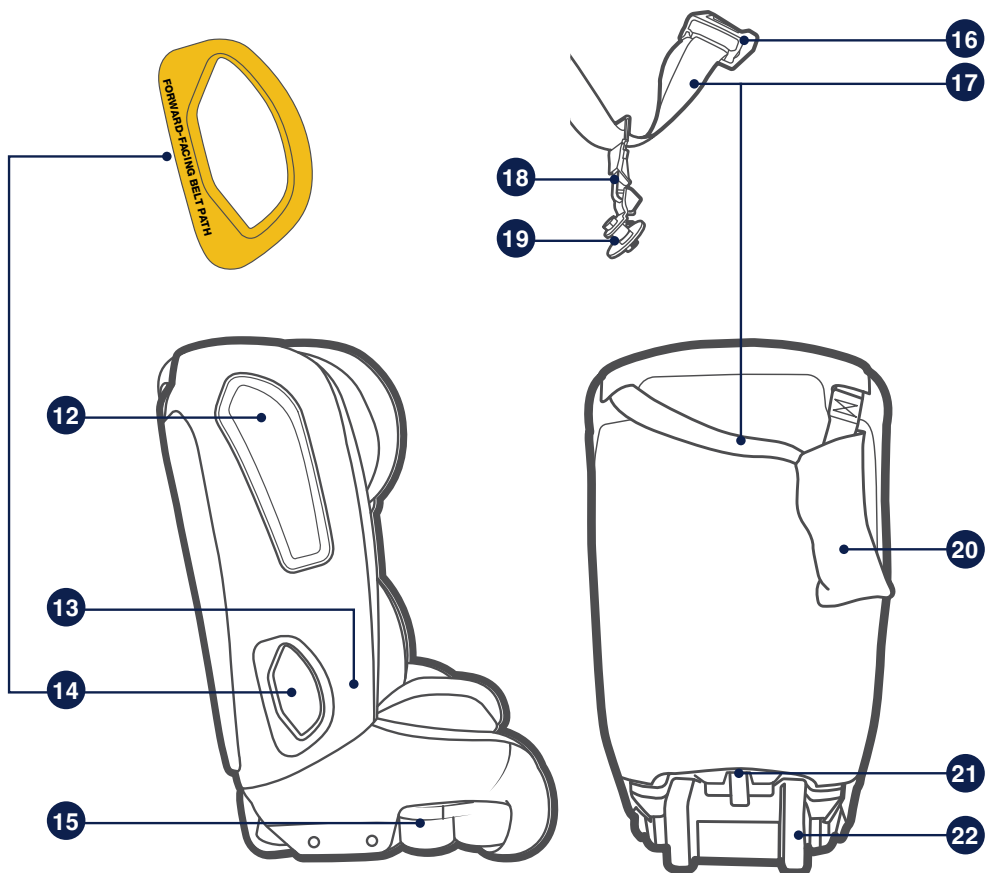

12. G-Cell (X2)

13. Magnetic Harness Holders (x2)

14. FORWARD-FACING BELT PATH (x2)

15. Cup Holders (x2)

16. Top Tether Strap Adjuster

17. Top Tether

18. Top Tether Hook

19. Anchor Fitting

20. Top Tether/Instruction Manual
Storage Pocket

21. Tether Hook Holder.

22. Recline Arm

Padding and Inserts

Combination guide

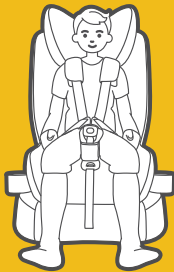
Mode	Padding / Inserts ¹	Setup Instructions
 <p>Forward Facing 6 months to 8 years (approx.)</p>	Remove Insert at approximately 12 months	See page 25

1. Padding / Inserts

The insert provided is to be used for this restraint only and is suitable for children aged between 6 months and 12 months approximately.

2. Age and Size Suitability

All ages are approximate; it is recommended that you follow the shoulder height markers on the seat when looking to change your child from other Rearward Facing seat to this Forward Facing seat or checking when your child has outgrown this seat.

Preparation before install

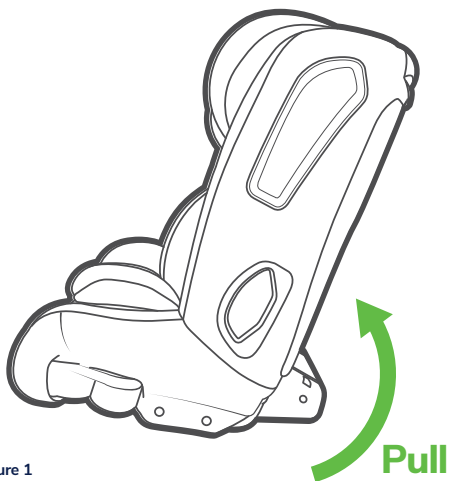

Figure 1

Recline adjustment

Select between reclined position and upright position.

The recline position is achieved by swinging the recline arm back (Figure 1).

To select the upright position, simply swing the recline arm back under the seat as shown (Figure 2).

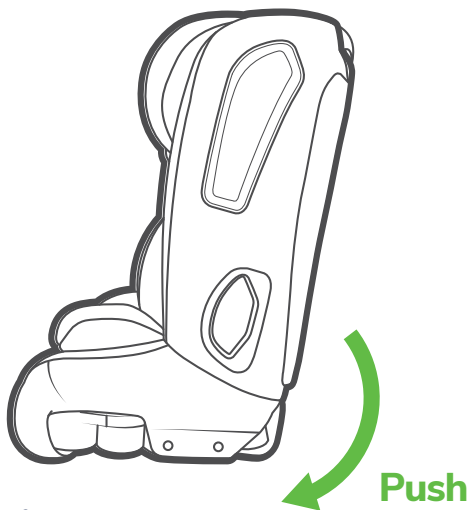

Figure 2

Forward Facing

Top tether adjustment

IMPORTANT: Always secure the loose end of the top tether strap to prevent it hanging out of the car or being accessible by the child.

Always adjust the top tether to the correct length before installing the car seat.

To Loosen Top Tether

Step 1. Press the grey button and pull on the main top tether strap with the top tether hook attached to it (Figure 3).

Step 2. Ensure to loosen and check that you have enough top tether slack to attach to your vehicles top anchorage location before beginning the installation process.

To Tighten Top Tether

To tighten top tether strap, pull on the free end of the tether to tighten (Figure 4).

Always store excess tether in the pocket provided (Figure 5).

CAUTION: children can be injured or restraints and top tether strap damaged by unsecured cargo in a collision. Secure or remove hazardous cargo before using this child restraint.

Figure 3

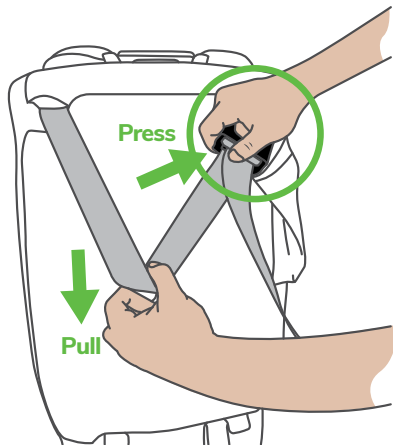

Figure 4

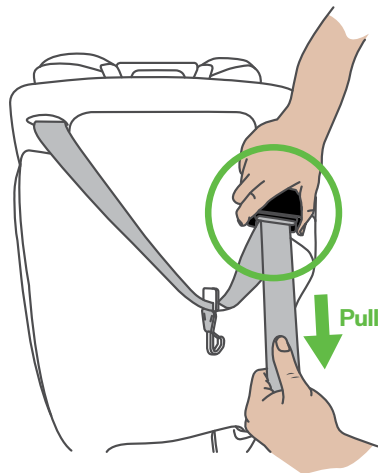

Figure 5



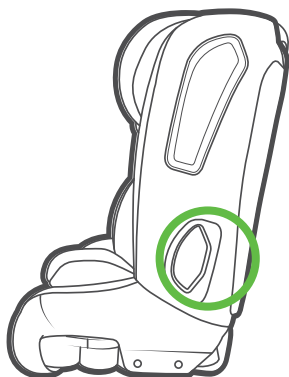

Figure 6

Forward facing belt path

IMPORTANT: Before installation, locate the Forward Facing belt path (Figure 6).

Always adjust the top tether to the correct length before installing the car seat.

Place child restraint in vehicle

Place restraint in forward facing position in vehicle (Figure 7).

Place restraint facing forwards on back seat of vehicle in line with a top tether strap anchorage point.

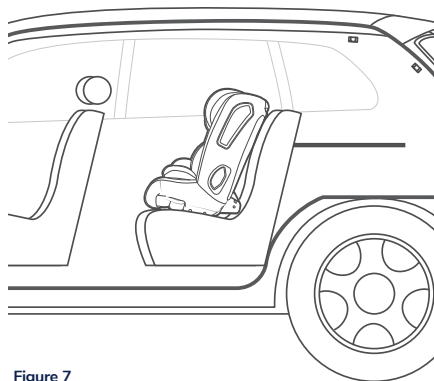

Figure 7

Forward Facing

Ensure there is enough room in vehicle

To ensure there is enough room in the vehicle, check the measurements between the vehicle's rear and front seats where the seat is to be installed (Figure 8).

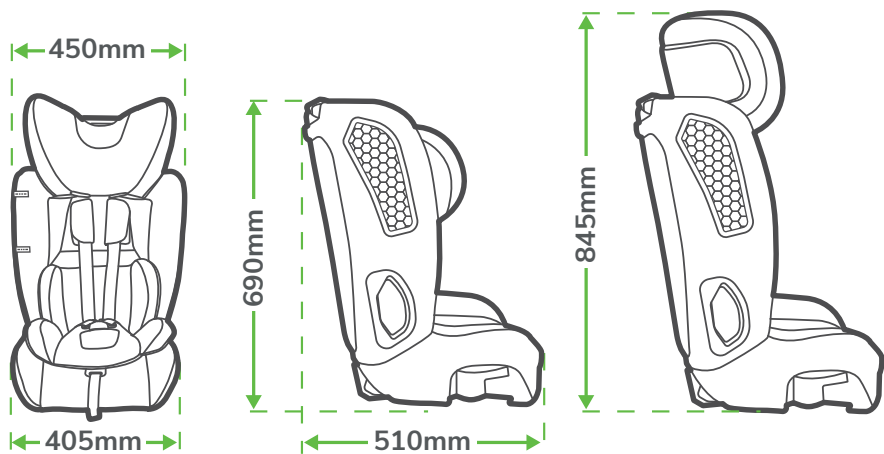

Figure 8



Forward Facing Instructions

Congratulations! Your child has reached their forward facing height markers. This seat is fully harnessed until approximately 8 years of age.

Here's a quick check list before you install this Tuva Harnessed Forward Facing car seat::

- ☒ Check that your child's shoulders reach the lower shoulder height marker for this seat.
- ☒ Check that your child's shoulders are NOT above the upper shoulder height marker, and if they are, your child may be ready for a larger booster or ready to use the car seatbelt.
- ☒ Check if your child needs the infant padding to fit snugly.
- ☒ You have selected the appropriate recline for your child.

Forward Facing

Install using Vehicle Seatbelt



How to position your car seat correctly

Step 1. Loosen the top tether.

Step 2. Place the restraint on the back seat of the vehicle in-line with a top tether strap anchorage point (Figure 1).

Step 3. Select the desired recline position by swinging the recline arm back for recline (Figure 2).

Step 4. To select the upright position, simply swing the recline arm back under the seat (Figure 3).

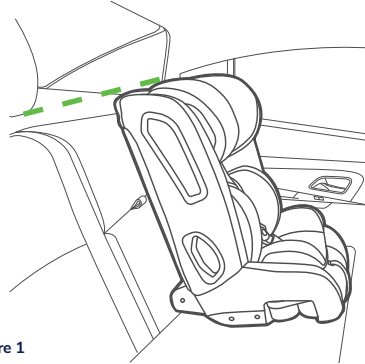

Figure 1

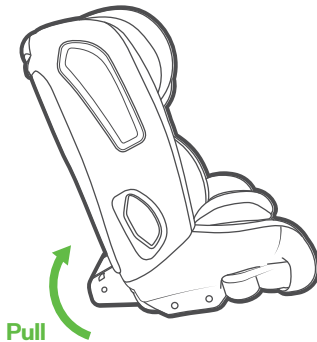

Figure 2

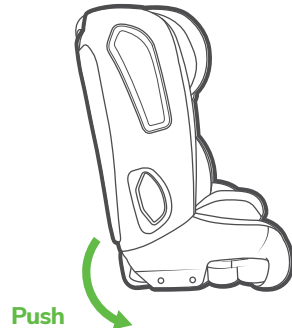

Figure 3

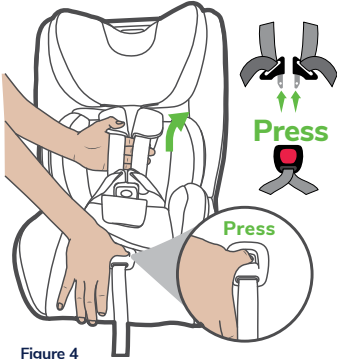

Figure 4

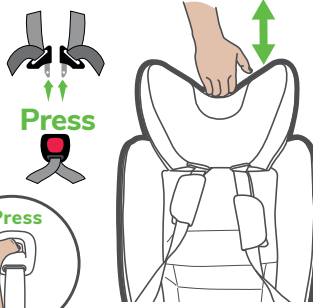

Figure 5

Adjust Headrest to a high position

Step 5. Unbuckle and Loosen car seat harness by pressing the harness release button, pulling the harness straps towards the front of the seat and disengage the harness buckle (Figure 4).

Step 6. Lift the grey handle located at the top of the headrest and lift up (Figure 5).

Route seatbelt through belt path

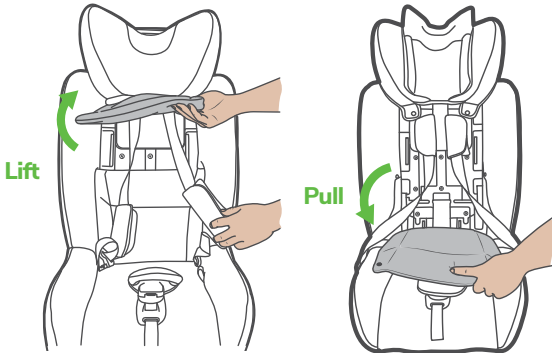

Figure 6

Step 7. Lift upper back trim and pull down lower back trim (Figure 6).

Step 8. Open the SMART Lock by lifting it until it rests against the back of the seat (Figure 7)

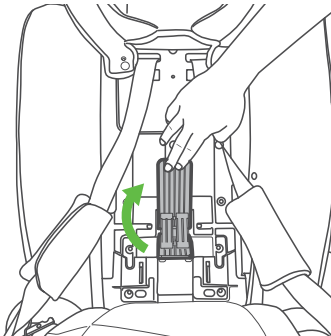

Figure 7

Forward Facing

Step 9. Thread the vehicle seatbelt through the side of the seat where the forward facing belt path is indicated. Ensure seat belt sitting on the top of the webbing (Figure 7).

Step 10. Pull the vehicle seatbelt across the back and through the SMART Lock belt channel, ensuring the seat belt is tucked under the 2 guiding tabs either side of the SMART Lock (Figure 8).

Step 11. Thread through to the other side (Figure 8) ensuring to feed behind the car seat trim Fasten the vehicle seat belt and listen for the click (Figure 8).

Ensure there are no twists in the seat belt.

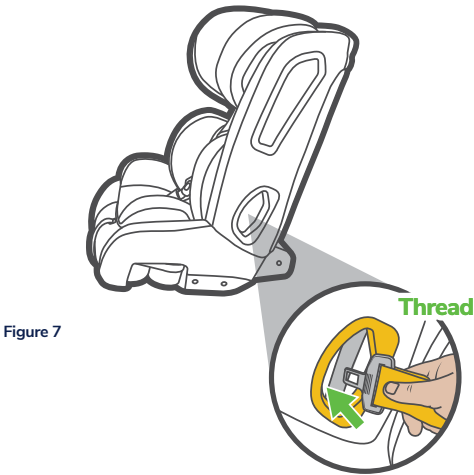

Figure 7

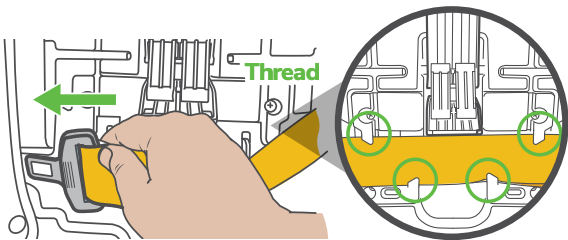

Figure 7

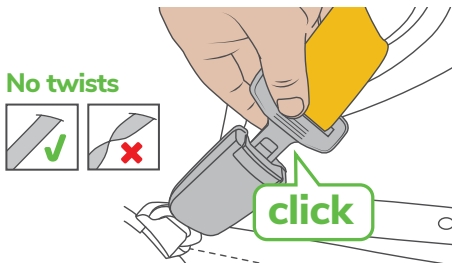

Figure 8

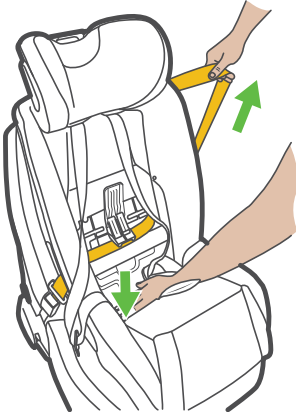

Figure 9

Step 12. Push on the base of the car seat while pulling on the seat belt to remove slack (Figure 9)..

Step 13. Close the SMART Lock lever, ensuring the belt tension indicators are both full green (Figure 10).

WARNING: A LOOSE SEATBELT IS DANGEROUS

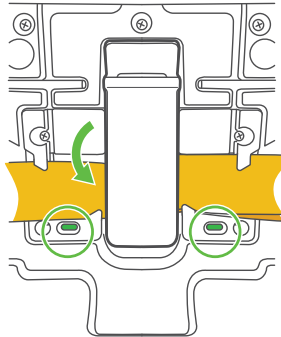

Figure 10

Forward Facing

Attaching the top tether strap

Attach the top tether strap to the top anchorage point in the vehicle (Figure 11). Ensure there are no twists in the top tether.

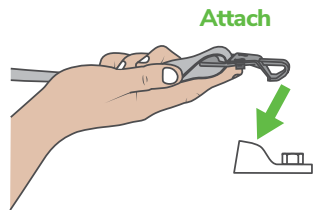
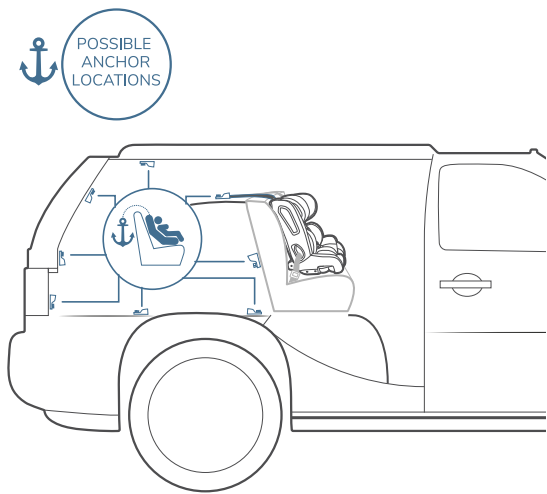

Figure 11

Location of anchor fitting

The anchor point can be found in different locations in different cars. The diagram above shows possible locations of anchor points. Sometimes it is on the parcel shelves in sedans, and on the floor in station wagons, vans and hatchbacks. Make sure that you do not confuse the luggage hook in the back of a station wagon with anchor points. Refer to your owner's manual.

An extension strap may be needed for vehicles without a fixed parcel shelf. Extension straps and extra fittings are available from various stores.



Dorel Extension Straps - 300mm
Dorel Extension Straps - 600mm

Figure 1

INSTALLATION

Anchorage in vertical panel at rear of vehicle



Correct

Make sure there is no slack in the top strap and the attachment clip is upright in the anchorage fitting.

Figure 2

INSTALLATION

Floor mounted anchorages

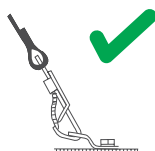

Correct

Make sure there is no slack in the top strap and the attachment clip is upright in the anchorage fitting.

Anchorage fitment check

Child restraints must be used correctly to provide proper protection for your child. The anchorage system on child restraint must be used in the correct way.

CORRECT

Make sure there is no slack in the top strap and the attachment clip is upright in the anchorage fitting.

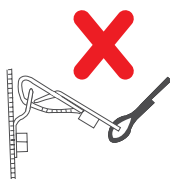

Incorrect

The clip must not lie flat on the anchorage fitting.

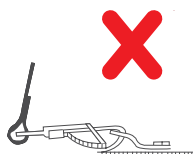

Incorrect

Make sure there is no slack in the top strap and the attachment clip is upright in the anchorage fitting.

INCORRECT

The clip must not lie flat in the anchorage fitting.

Remove slack from top tether

Step 1. Remove slack only. Do not over-tighten the top tether strap so that the restraint lifts up off the vehicle seat (Figure 12).

Step 2. Ensure there are no twists and turns in the top tether strap and that the adjuster is positioned facing outwards (Figure 12).

Note: There will be a half twist in the top tether strap between the adjuster and the shell of the restraint, allowing the adjuster to be positioned facing outwards (Figure 13).

Step 3. Roll up excess strap and store in the pocket provided on the cover (Figure 14).

CAUTION: CHILDREN CAN BE INJURED OR RESTRAINTS AND TOP TETHER STRAP DAMAGED BY UNSECURED CARGO IN A COLLISION. SECURE OR REMOVE HAZARDOUS CARGO BEFORE USING THIS CHILD RESTRAINT.

Always secure the loose end of the top tether strap to prevent it hanging out of the car or being accessible by the child.

When not in use, fold hanging tether strap and place in storage pocket provided.

No twists

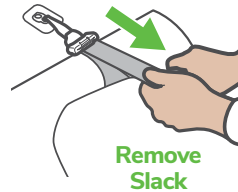
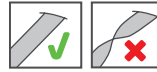

Figure 12

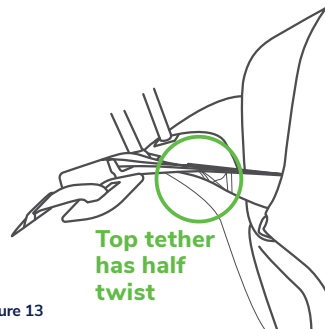
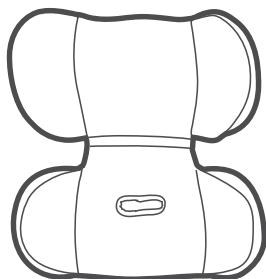

Figure 13



Figure 14

How to use



Infant Insert

The insert provided is to be used for this forward facing seat only and between the ages of 6 months to 12 months approximately.

Harness adjustment

To Loosen harness

Step 1. Press the harness release button at the front (Figure 1).

Step 2. Pull both shoulder straps simultaneously to loosen harness (Figure 1).

To tighten harness

Pull the harness adjuster strap at the front of the seat until the shoulder straps lay firmly against the child (Figure 2).

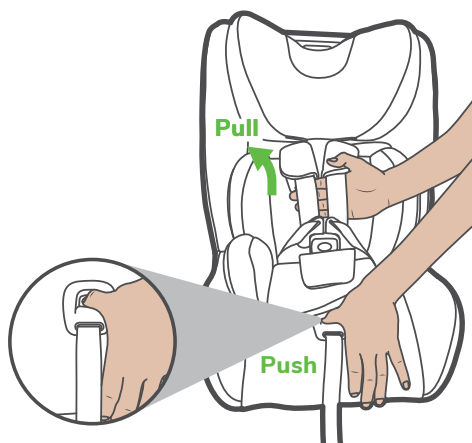

Figure 1

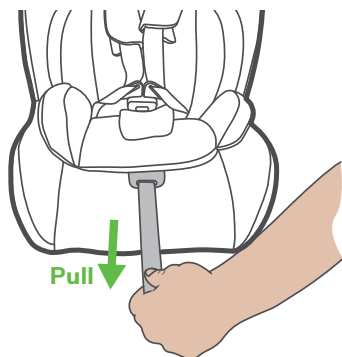

Figure 2

Forward Facing

Headrest and harness height adjustment

Lift the release handle located at the top of the headrest and lift up or push down to the desired height (Figure 6).

IMPORTANT: Always loosen the harness before moving the headrest up. Adjusting the headrest will automatically adjust the harness height as well.

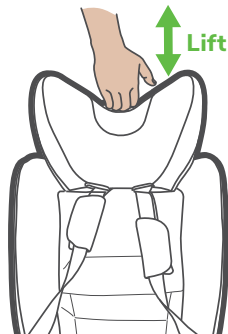

Figure 6

Fitting the harness to your child

Step 1. Loosen the harness and release the buckle by pressing the red button.

Step 2. Place the child in the seat (Figure 7).

Step 3. Fasten the buckle assembly (Figure 8).

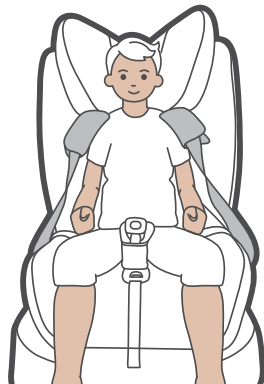

Figure 7

WARNING: ENSURE BUCKLE IS ALWAYS CONNECTED DURING USE.

WARNING: DO NOT LEAVE CHILDREN UNATTENDED IN THE CAR.

FAILURE TO FASTEN AND TIGHTEN THE HARNESS SYSTEM CORRECTLY CAN RESULT IN SERIOUS INJURY OR DEATH.

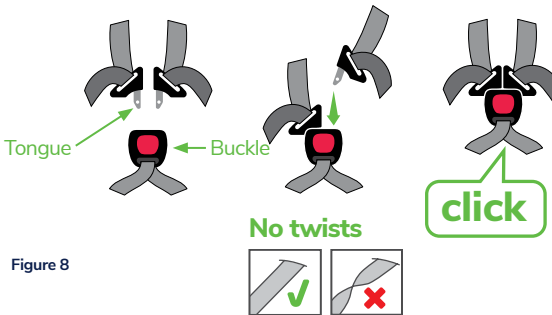

Figure 8

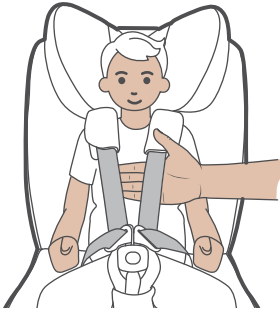

Figure 9

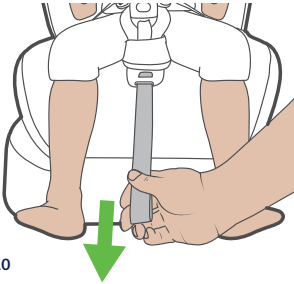

Figure 10



Figure 11

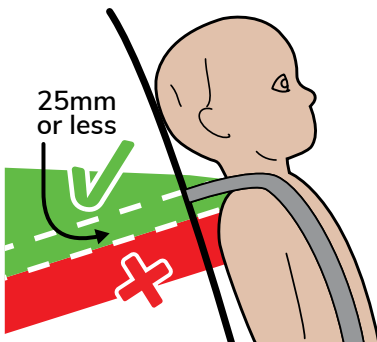

Figure 12

Tighten the harness

Step 1. Before pulling on adjuster strap to tighten harness, pull on harness shoulder straps first to remove slack from the waist area, feed slack from waist straps to shoulder straps if needed (Figure 9).

Step 2. Once slack is removed, pull on adjuster strap so that the harness over the shoulders is firm (Figure 10).

Step 3. Pinch the straps near the top of the shoulder to check for correct fitment. This is achieved when you are unable to pinch the harness (Figure 11). If you can pinch the harness, tighten more.

TIP Always use the Pinch test when you buckle your child as your harness may need adjusting.

WARNING: DO NOT LEAVE CHILDREN UNATTENDED IN THE CAR.

Harness straps in green zone

IMPORTANT: The shoulder straps must be in the slots which are nearest to the child's shoulders, but not more than 25mm below the child's shoulders (Figure 12).

CAUTION: Always adjust the height of the shoulder straps as the child grows.

Forward Facing

Crotch buckle height adjustment

When adjusting the buckle height, it should be positioned on the lower abdomen of the child when fastened (Figure 13).

As your child grows, this will need to be adjusted accordingly. This adjustment can be completed in the car so there is no need to undo your installation.

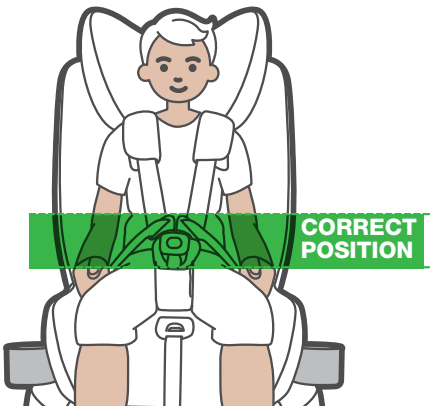

Figure 13

Increasing the Buckle Height:

Step 1. Release the press studs on the seat fabric's back panel and pull the back panel forward to expose the buckle's mounting points in the seat.

Step 2. Connected to the buckle strap is an adjuster, press on the lever and pull on the buckle simultaneously to extend the height (figure 14). Release the lever when the desired height is reached.

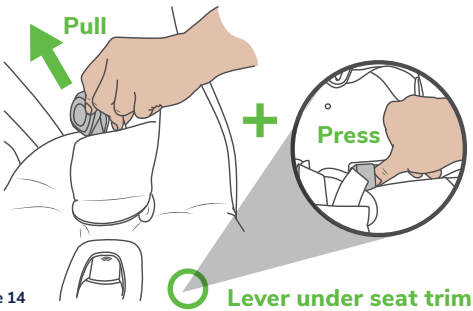

Figure 14

Lowering the Buckle Height:

Pull on the buckle adjuster strap (figure 15)

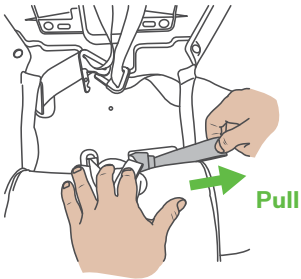

Figure 15

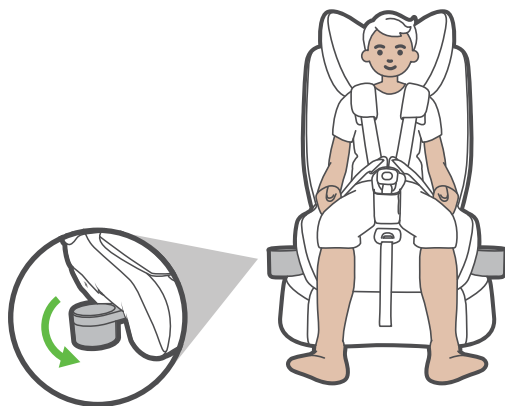

Figure 16

Cup Holders

Cup holders are located on either side of the car seat. Swing out to use and swing back in to stow away when not in use (Figure 16).

CAUTION: Do not use with hot beverages.

Top Tether attachment when not in use

Top tether hook attached to the notch at the back as shown (figure 17), and then tighten the top tether webbing to secure. This prevents top tether hanging out loosely which can cause injury or damages.

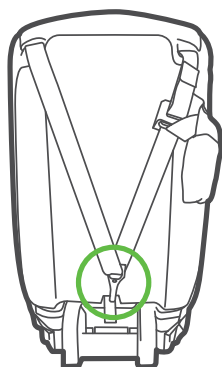

Figure 17

Check List

- ☑ Ensure this seat is installed forward facing.
- ☑ Ensure vehicle seatbelt is tensioned by SMART Lock. (page 21)
- ☑ Top tether firmly attached and strap tensioned but not over-tightened (page 24).
- ☑ Headrest and shoulder strap position is correct. (page 26 and 27).
- ☑ Harness buckle at lower abdomen. (page 28)
- ☑ Slack and twist on harness are fully removed. (page 26 and 27)

Notes

This image shows a single sheet of white paper with horizontal ruling lines. The lines are evenly spaced and run across the width of the page. There are no margins, text, or other markings on the paper.



Additional Information

Regularly checking and maintaining your seat will ensure your seat remains comfortable and safe for your child.

This section details information on:

- Seat Guide
- Care and maintenance
- Anchorage fittings
- Your Maxi-Cosi guarantee

Seat Guide

Your Tuva forward-facing harnessed car seat is suitable from 6 months to approximately 8 years of age. Once your child has out grown this seat, it is time for you to move your child into a booster seat. See page 42.

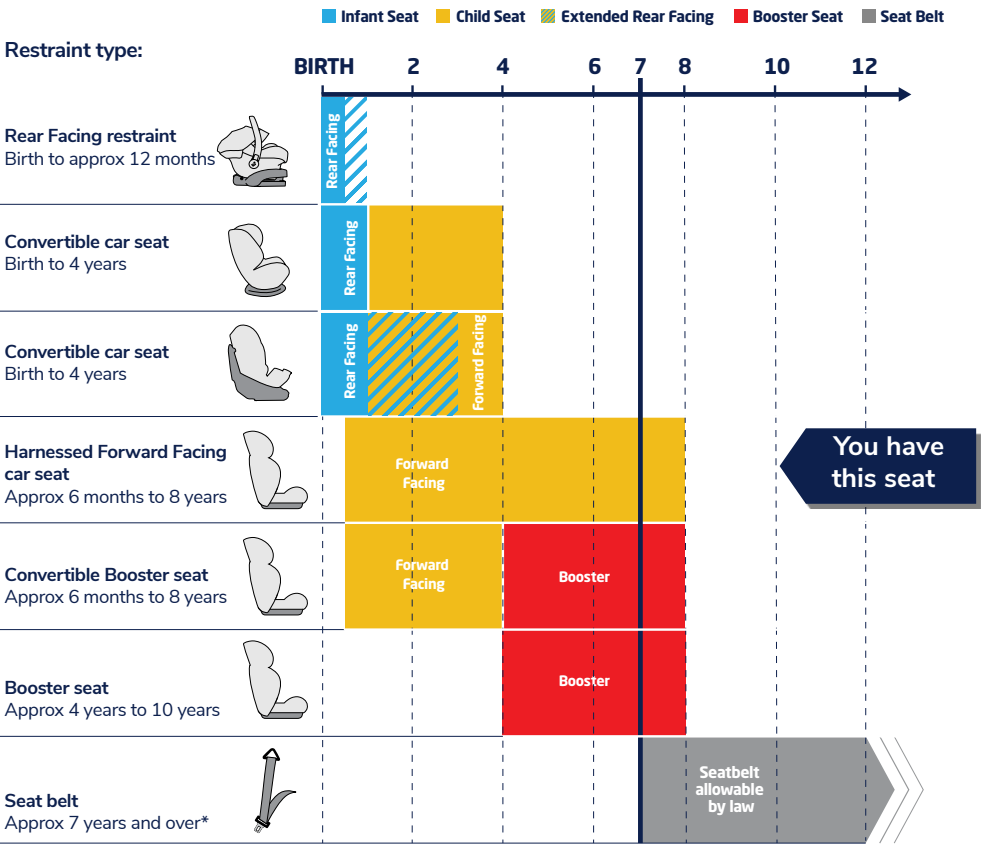

*Check with your local state regulations

Care and Maintenance

Caring for the Restraint Buckle

When caring for your restraint's buckle, follow the manufacturer's instructions at all times.

Your child seat is equipped with a buckle designed to give your child maximum protection during proper use. When working properly, your buckle should always fasten with an audible 'CLICK'.

If sticky liquids (such as baby food, fruit juice, etc.) get into the buckle it may become sluggish and you will not hear a 'CLICK'.

The buckle should be cleaned by following the steps below.

Cleaning the buckle

Step 1: Start by adjusting the crotch buckle to maximum length.

Step 2: You can remove the seat trim cover so it does not get wet or dirty during the cleaning process.

Step 3: Fill any shallow container with 40°C water.

Step 4: Lay the buckle gently into the container and let it soak for 30 mins (Figure 1).

Step 5: Simultaneously latch and unlatch the buckle tongues into the buckle several times until a strong audible CLICK is heard.

If you cannot hear an audible CLICK then repeat steps 1-4 above again.

Step 6: Allow the buckle to completely dry before fitting on the trim.

Caution:

Do not oil any part of buckle. Water may be hot so proceed with care.

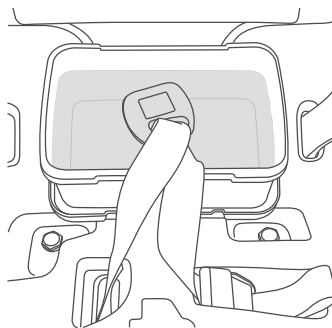

Figure 1

NOTE: If the buckle does not return to original working order, contact Dorel Australia Customer Service on 1300 809 526.

If you are a New Zealand customer, please contact IGC Dorel New Zealand Customer Service on 0800 628 000.

To remove fabric accessories

DO NOT remove any of the harness parts to remove any of the cover (trim) or padding.

Step 1. Remove harness pads and insert (Figures 1, 2).

Step 2. Unhook and remove crotch pad from body trim (Figures 3, 4).

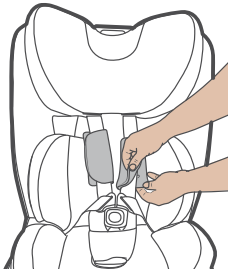

Figure 1

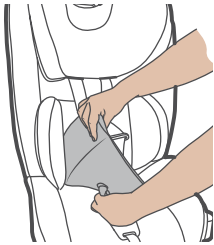

Figure 2

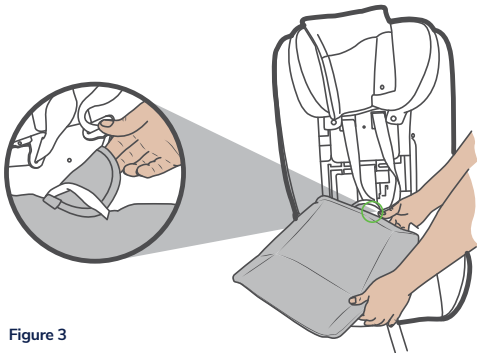

Figure 3

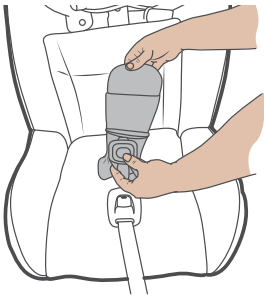

Figure 4

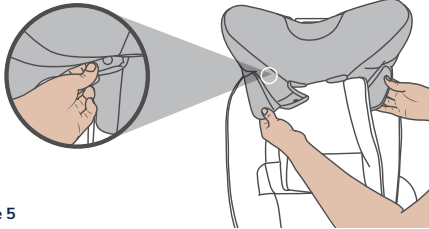

Figure 5

Step 3. Adjust headrest to highest position. Undo fasteners on the headrest pad (Figure 5)

Step 4. Gently remove headrest pad off the headrest, starting from bottom to top (Figures 5, 6).

Step 5. Adjust headrest to lowest position.

Step 6. Undo all fasteners on the body trim from the hard goods (Figure 7).

Step 7. Unlatch body trim from around crotch area (Figure 8),



Figure 6

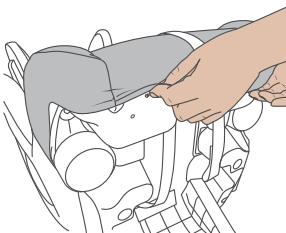

Figure 7

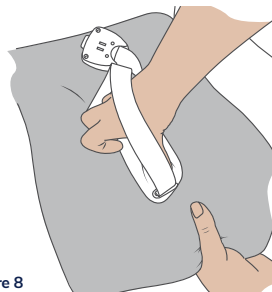

Figure 8

Step 8. Undo all fasteners, unlatch body trim from around GCell and yellow side panel (Figures 9, 10, 11) .

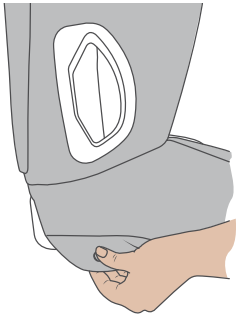

Figure 9

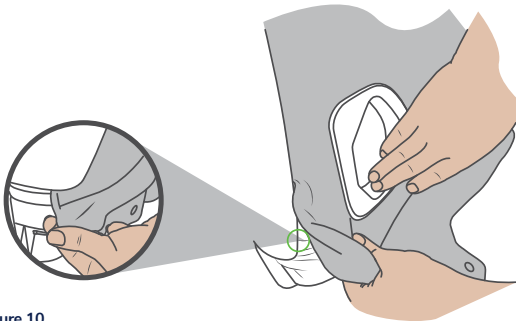

Figure 10

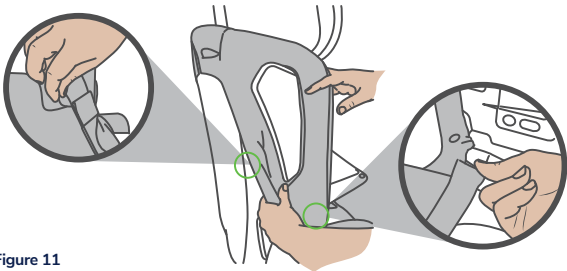

Figure 11

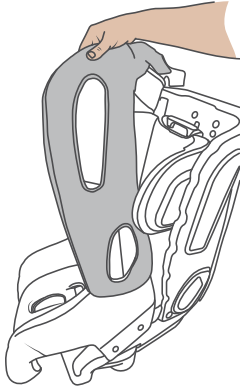
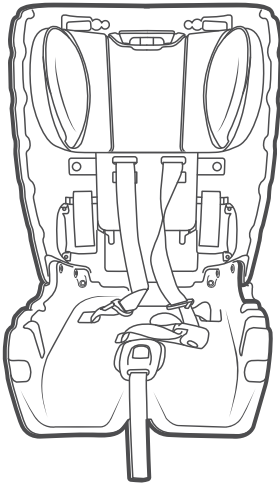

Figure 12

Step 9. Carefully remove body trim from the hardgoods, starting from top to bottom (Figure 12).



Cleaning Pad & Top Harness
Cover & Accessories

Top harness cover only can be machine washed. Must turn seat pad inside-out before machine washing. Machine wash separately with cold water on a gentle cycle. Do not use bleach. Tumble dry separately for 10-12 minutes on low heat. Remove immediately.

Infant insert: place inside pillow case. Do not use bleach. Tumble dry separately for 10-12 minutes on low heat. Remove immediately.

Cleaning harness strap &
bottom harness cover

Check the harness straps often for any wear or damage.

Spot clean using warm sudsy water and damp cloth. Spilled food and liquids on the seat may result in mold or bacterial growth over time. These spills could also attract insects or rodents.

Washing instructions



Lukewarm setting
– delicate cycle.



Tumble dry 10-15
minutes on low heat.



Do not dry clean.



Never clean with bleach
or spirit-type cleaners.



All other surfaces should be cleaned
with a mild soap and water.

VERY IMPORTANT:

Only replace the cover with a
manufacturer's supplied replacement
cover with identical shoulder height
markers or a replacement cover meeting
AS/NZS 8005.



WARNING

**DO NOT USE THE CHILD RESTRAINT WITHOUT THE SEAT COVER OR
WITH DAMAGED HARNESS STRAPS.**

Install Upper Anchorage

For cars fitted with a child restraint upper anchorage point

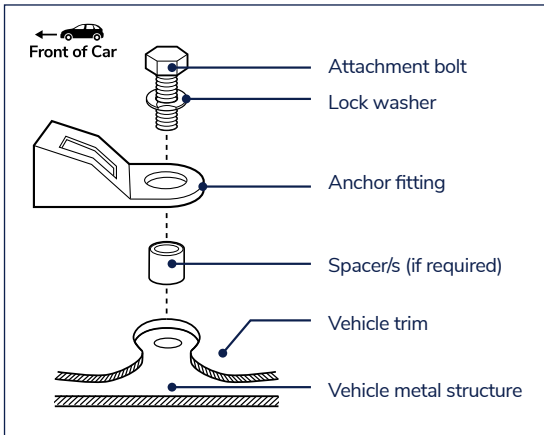

Figure 1

Locate the upper anchorage point behind the rear seating position (consult the vehicle owner's handbook for the location of the upper anchorage point).

Remove the thread plug from the parcel shelf/floor/roof and install the attachment bolt as shown in Figure 1.

CAUTION: DO NOT OVER-TIGHTEN THE ATTACHMENT BOLT. OVER-TIGHTENING MAY FRACTURE OR BREAK BOLT. MAXIMUM TORQUE IS 20 NM.

For cars not fitted with a child restraint upper anchorage point

For sedans only

Drill a 9mm diameter hole in the parcel shelf on the centre-line of the seating position as shown in Figure 2.

Install the anchor bolt as shown in Figure 3. It is recommended that this installation be carried out by a child restraint fitting station or licenced motor mechanic.

For vehicles other than sedans

In Australia, consult your nearest child restraint fitting station or traffic authority for vehicle inspection to find the best, correct position for the placement of the upper anchorage point, and for the correct attachment bolt length and use of spacers. In New Zealand, consult the agent for the vehicle.

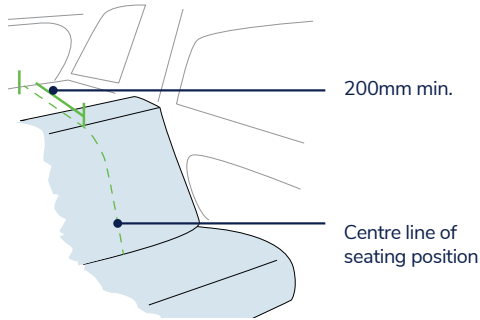

Figure 2

! WARNING

CHILD RESTRAINTS MUST NOT BE ATTACHED TO UNSOUND METAL OR TO WOOD OR SYNTHETIC STRUCTURES. WHEN DRILLING THE 9MM HOLE DO NOT DRILL THROUGH FUEL LINES, FUEL TANKS, ELECTRICAL WIRING, OR RADIO SPEAKERS. WEBBING STRAPS MUST BE PROTECTED FROM SHARP CORNERS AND EDGES.

THE ANCHOR FITTING MUST BE USED ONLY AS DESCRIBED ABOVE. IT MUST NOT BE HOOKED ONTO ANY OTHER OBJECT.

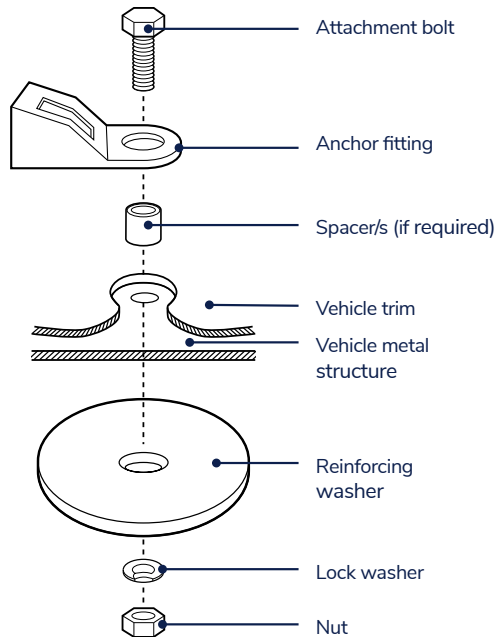

Figure 3

Accessories

Additional accessories

An extension strap may be needed for vehicles without a fixed parcel shelf. Extension straps and extra fittings are available from various stores.

Use of aftermarket accessories (i.e. items not provided in the box with the child restraint), can reduce the safety provided by the child restraint and may cause injury or death.

If an aftermarket accessory is to be used then the manufacturer may advise that it is compliant with AS/NZS 8005 and is stated as suitable for this child restraint.



Dorel Extension Straps - 300mm & 600mm



Dorel Locking clip

Dorel Extension Straps - 300mm
Dorel Extension Straps - 600mm

Seat Guide

The next seat for your child

LARGER BOOSTER SEAT

When your child has outgrown the seat, you can use a booster seat suitable for children up to 8-10 years of age until their shoulders reach the upper height marker of the booster seat.

NOTE: This illustration is representative only. Alternatively, follow the steps below to see if your child is ready to use a vehicle seat belt. If your child is transitioning out of a booster, try this simple three point test. You may find that your child is not yet ready to use an adult seatbelt without the booster.

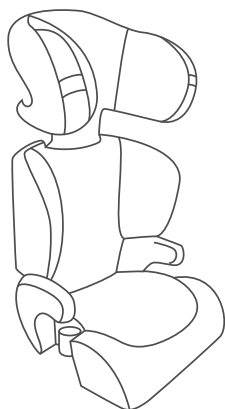

INCORRECT

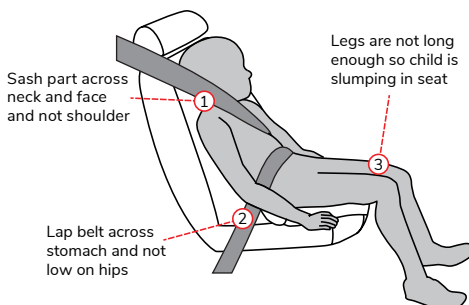

CORRECT

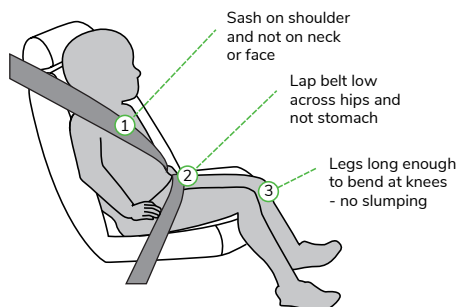

Information obtained from www.raa.com.au

Guarantee

Dorel Australia Pty Ltd warrants your new product to be free from defects in materials and workmanship for 10 years on the seat & 3 years on the trim, from the date of purchase, provided that the product is used in accordance with accompanying recommendations or instructions where provided. The benefit of this warranty is in addition to your rights under the Australian consumer law and to other rights and remedies of the consumer under a law in relation to the goods or services to which the warranty relates.

Dorel Australia Pty Ltd will provide you with your choice of a refund, repair or exchange (where possible) for this product if it becomes defective within the warranty period. Dorel Australia Pty Ltd will bear the reasonable expense of claiming the warranty. This warranty will no longer apply where the defect is a result of alteration, accident, misuse, abuse or neglect.

Please retain your receipt as proof of purchase or register your product with us within 3 months from point of purchase via our website **www.maxi-cosi.com.au**. If you are having difficulties with your product contact our Customer Service Team on ph: 1300 809 526 or alternatively, via our website at **www.maxi-cosi.com.au**. Warranty claims and claims for expense incurred in returning this product can be addressed to our **Customer Service Team at Warehouse 2, 30 Taras Avenue, Altona North, VIC 3025**. Hours: 8:30 am to 5:00 pm, Monday to Friday.

For New Zealand please contact **Customer Service Centre, 14 Sir William Avenue, East Tamaki, Auckland, 2013**. Auckland: **(09) 274 1040** NZ wide: **0800 628 000** (toll free). Hours: 8:00am - 4:00pm, Monday to Friday.

Our goods come with guarantees that cannot be excluded under the Australian consumer law. You are entitled to a replacement or refund for a major failure and compensation for any other reasonably foreseeable loss or damage. You are also entitled to have the goods repaired or replaced if the goods fail to be of acceptable quality and the failure does not amount to a major failure.



Don't forget to register your product
within 3 months of purchase for
the Lifetime Warranty offer.*

Please visit to register now.

www.maxi-cosi.com.au

© 2024 Dorel Australia, Pty Ltd. All Rights Reserved.
GM-13-D-G-AG 11/2024_FA_02

*Terms and conditions apply.
Please visit our website to find out more.

